

ISOLA COAST

A Prestigious Collection Of Waterfront Homes



*island [noun] a piece of land
surrounded by water.*

Amidst the shimmering sea and
calming breeze, Isola is an
island paradise unto its own.

ISOLA

Luxury Living On An Island Paradise

Discover Isola in Senibong Cove, a gorgeous island paradise tucked away from the bustle of the outside world yet with all the amenities you need just minutes away. In this waterfront haven, we believe that it is the ultimate luxury to combine passion with quality to create a path for blissfulness for the whole family. Welcome to your new home - Isola Coast.





Artist's Impression Only

The Art Of Coastal Living

Isola Coast is an exclusive, low-density community consisting of 160 luxurious homes. Feel the prestige of this exceptional new precinct where you will dance with lush greenery, be comforted by the calming sounds of waterfront living and be fully immersed in luxury living by the coastline.

Special Features



Last Landed
Precinct In Isola



Gated & Guarded
Precinct



Lush Greens
& Parks



Waterfront
Living



Dedicated
Clubhouse



Embrace An Oasis Of Nature

Experience the wonders of nature
with the calming green spaces
between each home.



Embrace Serenity By The Waterside

Set your normal pace to a different beat, Isola Coast is a wondrous source of fascination. There something appealing about living by the water while having your very own private garden.



Clubhouse & Lifestyle Facilities



Swimming Pool



Gymnasium



Playground



Jogging Path



Function Room



Viewing Deck

Wholesome Healthy Living Personified

Come home to a wholesome environment that features a clubhouse with a myriad of facilities dedicated to enriching your lifestyle. Enjoy the Infinity Pool that faces a water canal, ensuring a one-of-a-kind relaxing experience.



A Realm Of Natural Wonder

Isola Coast features a lush linear park - a therapeutic retreat for your senses. Immerse yourself in the beauty of nature as you escape the hustle and bustle of the city.

Site Plan



Well-Connected For Convenience

Isola Coast is just a short drive to Singapore from Johor Bahru's CIQ via the EDL, which also places you in proximity to JB City Centre's shopping malls, restaurants and other lifestyle conveniences.



GPS Coordinates:
Latitude 1.484211°
Longitude 103.832194°

5KM

- AEON Permas Jaya • Permas Jaya Golf Club
- REAL Private and International Schools

10KM

- Regency Specialist Hospital • Gaint
- Lebuhraya EDL • KPJ Pasir Gudang Specialist Hospital
- Mid Valley Southkey • Lotus's Plentong • Daiman 18 Golf Course

15KM

- Bukit Chagar RTS station • KOMTAR JBCC • Ponderosa Golf & Country Club
- Woodlands Checkpoint • AEON Mall Tebrau City • Toppen Shopping Centre
- Sultan Ismail Hospital • Sultanah Aminah Hospital

11 KM



RTS

13 KM

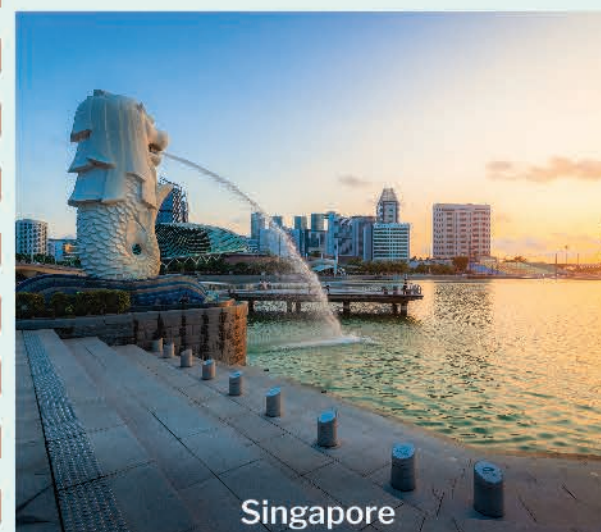

Singapore

12 KM



JB City Centre

30 KM



Senai International Airport



A JOHOR BAHRU CITY CENTRE

- Upgrading of Central Business District
- Customs, Immigration and Quarantine Complex (CIQ)
- JB-Singapore Causeway
- Proposed Rapid Transit System (RTS) - Woodlands / Johor Bahru City

B ISKANDAR PUTERI

- Kota Iskandar (Johor State Administrative Centre)
- EduCity
- Theme Parks
- Medical Park
- Legoland

C WESTERN GATE DEVELOPMENT

- Port of Tanjung Pelepas
- Malaysia - Singapore Second Link
- Tanjung Piai
- Tanjung Bin Power Plant
- RAMSAR World Heritage Site

D EASTERN GATE DEVELOPMENT

- Tanjung Langsat Industrial Complex
- Johor Port
- Tanjung Langsat Port
- Pasir Gudang Industrial Park

E SENAI-SKUDAI

- Senai International Airport
- Senai High-Tech Park
- MSC Cyberport City
- Senai Cargo Hub
- Sedenak Industrial Park
- Johor Technology Park



Urban Transformation Specialists

Creating a vision and turning it into reality drives our company's philosophy. Where others see a challenge, we see an opportunity.

Creating the best and being proud of what we do, ensures Walker stands-out from the competition.

We don't just masterplan a community, we become part of the community. Placemaking is all about creating vibrant, attractive spaces for communities to thrive in and this is our expertise.

The Walker team will always set the benchmark in sustainable, urban transformations which promote health and wellbeing, create economic opportunities and build resilient places.

From vision to reality, that's the Walker way.

LANG WALKER AO
Executive Chairman
Walker Group Holdings Pty Ltd

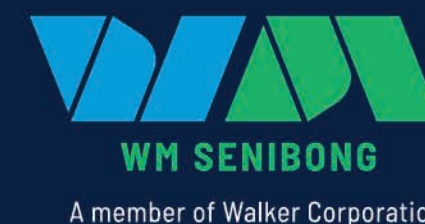

Where Passion Meets Expertise

WM Senibong is affiliated to Walker Corporation, Australia's largest private, diversified development company. In Malaysia, WM Senibong is renowned for the waterfront jewel, Senibong Cove, in Johor Bahru.

A winner of multiple real estate awards and accolades, WM Senibong believes that each and every development is a testament of the company's deep sense of commitment to sustainability, community and belonging.

As a master-planner of communities, our vision is to create places to live, work, socialise and play. To create homes which are truly a legacy for the next generation.

Developed by:

Senibong Cove Development Sdn Bhd (368215-X)

N-01, Blok N, Penggiran Senibong
No. 1 Perisaran Senibong, Teluk Senibong
81750 Masai, Johor, Malaysia.

F: +607 382 2600

T +607 382 0330

senibongcove.my

• Developer's License No: 11115/01-2028/0274 (A) (22/01/2023- 21/01/2028) • Advertisement & Sales Permit No.: 11115-8/10-2026/1114(N)-(S) (05/10/2023- 04/10/2026) • Building Type: 3 Storey Terrace House • Total units: 40 units • Selling Price: RM1,978,000.00 (min) – RM3,018,000.00 (max) • Approving Authority: Majlis Bandaraya Johor Bahru (MBJB) • Approved Plan No: MBJB/U/2022/14/BGN/111/RP (11) • Expected Date of Completion: November 2026 • Land Tenure: Freehold • Land Encumbrances: Nil • 15% discount for Bumiputera lot • Sekatan-Sekatan Kepentingan: Tanah yang terkandung di dalam hakmilik ini tidak boleh dijual atau dipindahmilik dengan apa cara sekalipun kepada Bukan Warganegara/Syarikat Asing tanpa persetujuan Pihak Berkuasa Negeri.

THIS ADVERTISEMENT HAS BEEN APPROVED BY THE NATIONAL HOUSING DEPARTMENT

Disclaimer: The information contained in this brochure may be changed or deleted or altered at any time without prior notice and/or subject to amendments as may be required by the developer, the authorities and the developer's consultants from time to time. Purchasers are advised to refer to actual information, specifications or plans as inserted in the stamped Sales and Purchase Agreement entered into between the developer and the purchaser. All drawings are merely artist impressions only.

A PROJECT BY:  **WM SENIBONG**

A member of Walker Corporation



Front Facade

Artist's Impression Only

Violet

3-Storey Link House
22' x 111'
Built-Up: 3685 / 3775 sq.ft.



Back Facade

Artist's Impression Only



Ground Floor

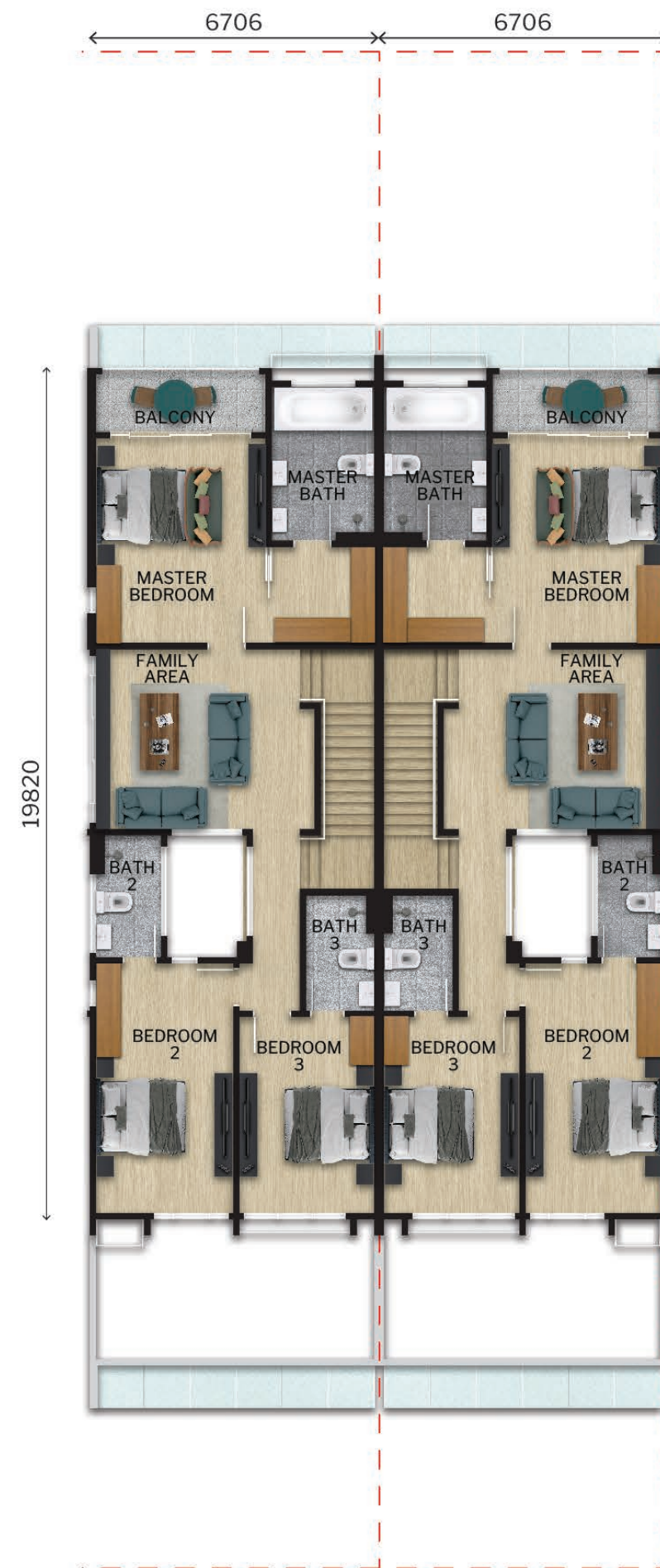

First Floor

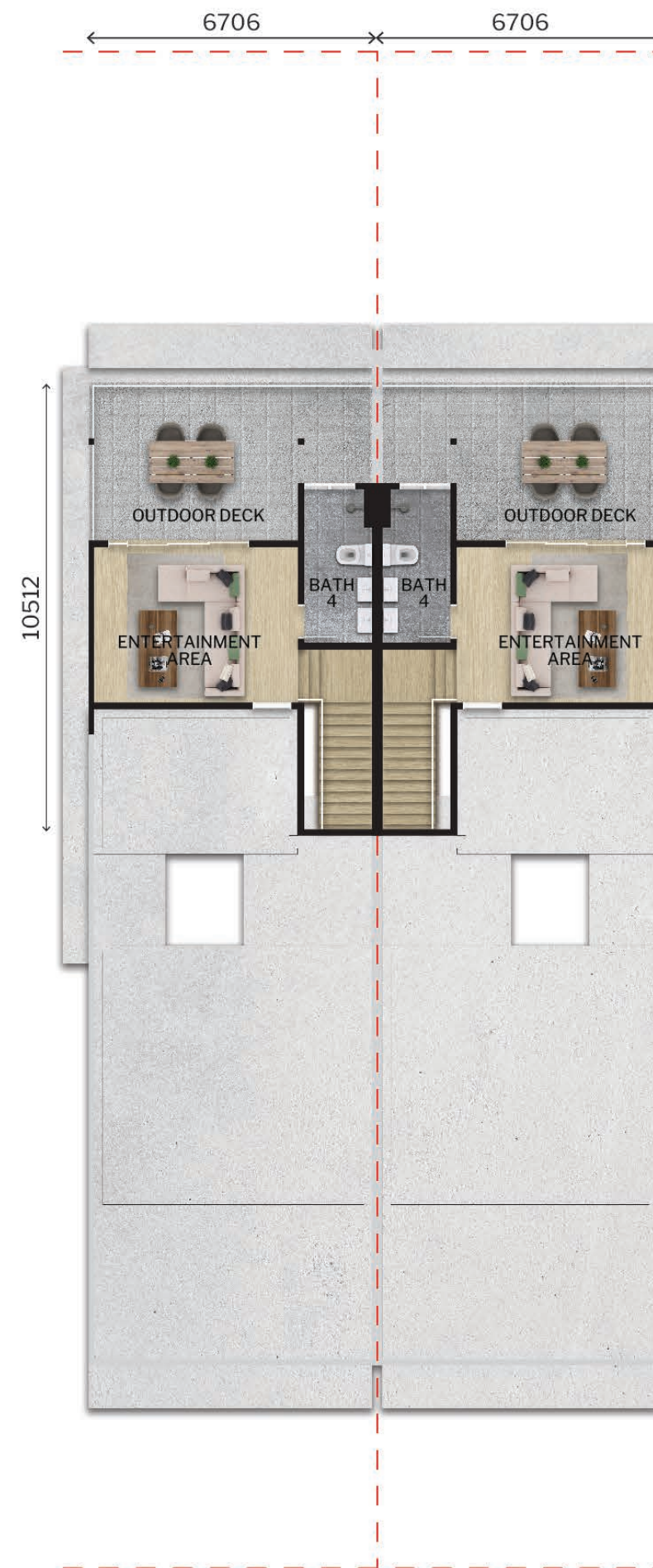

Second Floor

Specification

Structure	: Reinforced Concrete Framework	
Wall	: Clay Bricks	
Roofing Covering	: Metal Roofing / R.C Flat Roof	
Roof Framing	: Light Weight Steel	
Ceilings	: Fibrous Plaster Ceiling / Cement Board Panel / Skim Coat	
Windows	: Aluminium Framed Glass Windows	
Doors	: Aluminium Framed Glass Doors / Plywood Flush Doors / Mild Steel Grille Door (Corner / End)	
Ironmongery	: Selected Quality Ironmongeries	
Wall Finishes	: Ceramic Wall Tiles at Bathrooms	
	: Ceramic Wall Tiles at Wet Kitchen	
Floor Finishes	Ground Floor	
	: Deck, Porch & Driveway, Kitchen, Yard, Utility, Toilet & Powder Room	: Ceramic Tiles
	: Foyer, Bedroom 4, Dining & Living	: Porcelain Tiles
	: Store	: Cement Render
	: Courtyard	: Loose Gravel Chips
Floor Finishes	First Floor	
	: Master Bedroom, 2, 3 & Family Area	: Hard wood timber Parquet
	: Master Bath, 2, 3 & Balcony	: Ceramic Tiles
Floor Finishes	Second Floor	
	: Entertainment Area	: Hard wood timber Parquet
	: Bath 4 & Outdoor Deck	: Ceramic Tiles
	: Other Areas	: Cement Render
Staircase	: R.C Staircase With Hard Wood Parquet to Tread / Plaster Finish to Riser	
Sanitary and Plumbing Fittings	: Selected Quality Sanitary Wares	
Electrical Installation	: Lighting Point	: 45 nos
	: Fan Point	: 7 nos
	: Socket Outlet Point	: 30 nos
	: TV Outlet Point	: 2 nos
	: Telephone Point	: 1 no
	: Air-con Point	: 6 nos
	: Heater Point	: 1 no
	: Bell Point	: 1 no
	: Alarm Wiring	: 1 no
	: Internet Point	: 4 nos
Internal Telephone Trunking & Cabling	: Available	
Fencing	: 3' High Galvanised Mesh Fence	

• Developer's License No: 11115/01-2028/0274 (A) (22/01/2023- 21/01/2028) • Advertisement & Sales Permit No.: 11115-8/10-2026/1114(N)-(S) (05/10/2023- 04/10/2026) • Building Type: 3 Storey Terrace House • Total units: 40 units • Selling Price: RM1,978,000.00 (min) – RM3,018,000.00 (max) • Approving Authority: Majlis Bandaraya Johor Bahru (MBJB) • Approved Plan No: MBJB/U/2022/14/BGN/111/RP (11) • Expected Date of Completion: November 2026 • Land Tenure: Freehold • Land Encumbrances: Nil • 15% discount for Bumiputera lot • Sekatan-Sekatan Kepentingan: Tanah yang terkandung di dalam hakmilik ini tidak boleh dijual atau dipindahterik dengan apa cara sekalipun kepada Bukan Warganegara/Syarikat Asing tanpa persetujuan Pihak Berkuasa Negeri.

THIS ADVERTISEMENT HAS BEEN APPROVED BY THE NATIONAL HOUSING DEPARTMENT

Disclaimer: The information contained in this brochure may be changed or deleted or altered at any time without prior notice and/or subject to amendments as may be required by the developer, the authorities and the developer's consultants from time to time. Purchasers are advised to refer to actual information, specifications or plans as inserted in the stamped Sales and Purchase Agreement entered into between the developer and the purchaser. All drawings are merely artist impressions only.



Front Facade

Artist's Impression Only

Lilac

3-Storey Link House
22' x 130'
Built-Up: 3685 / 3775 sq.ft.



Back Facade

Artist's Impression Only



Ground Floor



First Floor

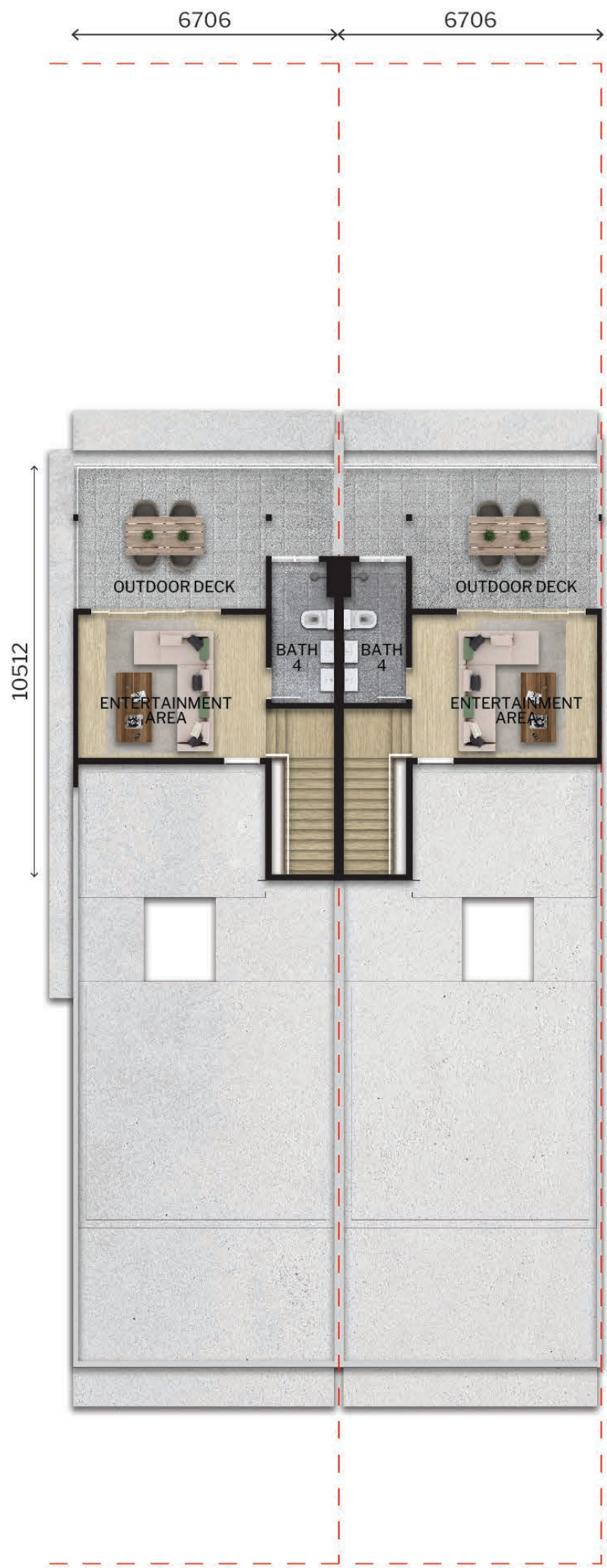

Second Floor

Specification

Structure	: Reinforced Concrete Framework	
Wall	: Clay Bricks	
Roofing Covering	: Metal Roofing / R.C Flat Roof	
Roof Framing	: Light Weight Steel	
Ceilings	: Fibrous Plaster Ceiling / Cement Board Panel / Skim Coat	
Windows	: Aluminium Framed Glass Windows	
Doors	: Aluminium Framed Glass Doors / Plywood Flush Doors / Mild Steel Grille Door (Corner / End)	
Ironmongery	: Selected Quality Ironmongeries	
Wall Finishes	: Ceramic Wall Tiles at Bathrooms : Ceramic Wall Tiles at Wet Kitchen	
Floor Finishes	Ground Floor : Deck, Porch & Driveway, Kitchen, Yard, Utility, Toilet & Powder Room : Foyer, Bedroom 4, Dining & Living : Store : Courtyard	: Ceramic Tiles : Porcelain Tiles : Cement Render : Loose Gravel Chips
Floor Finishes	First Floor : Master Bedroom, 2, 3 & Family Area : Master Bath, 2, 3 & Balcony	: Hard wood timber Parquet : Ceramic Tiles
Floor Finishes	Second Floor : Entertainment Area : Bath 4 & Outdoor Deck : Other Areas	: Hard wood timber Parquet : Ceramic Tiles : Cement Render
Staircase	: R.C Staircase With Hard Wood Parquet to Tread / Plaster Finish to Riser	
Sanitary and Plumbing Fittings	: Selected Quality Sanitary Wares	
Electrical Installation	: Lighting Point	: 45 nos
	: Fan Point	: 7 nos
	: Socket Outlet Point	: 30 nos
	: TV Outlet Point	: 2 nos
	: Telephone Point	: 1 no
	: Air-con Point	: 6 nos
	: Heater Point	: 1 no
	: Bell Point	: 1 no
	: Alarm Wiring	: 1 no
	: Internet Point	: 4 nos
Internal Telephone Trunking & Cabling	: Available	
Fencing	: 3' High Galvanised Mesh Fence	

• Developer's License No: 11115/01-2028/0274 (A) (22/01/2023- 21/01/2028) • Advertisement & Sales Permit No.: 11115-8/10-2026/1114(N)-(S) (05/10/2023- 04/10/2026) • Building Type: 3 Storey Terrace House • Total units: 40 units • Selling Price: RM1,978,000.00 (min) – RM3,018,000.00 (max) • Approving Authority: Majlis Bandaraya Johor Bahru (MBJB) • Approved Plan No: MBJB/U/2022/14/BGN/111/RP (11) • Expected Date of Completion: November 2026 • Land Tenure: Freehold • Land Encumbrances: Nil • 15% discount for Bumiputera lot • Sekatan-Sekatan Kepentingan: Tanah yang terkandung di dalam hakmilik ini tidak boleh dijual atau dipindahmilik dengan apa cara sekalipun kepada Bukan Warganegara/Syarikat Asing tanpa persetujuan Pihak Berkuasa Negeri.

THIS ADVERTISEMENT HAS BEEN APPROVED BY THE NATIONAL HOUSING DEPARTMENT

Disclaimer: The information contained in this brochure may be changed or deleted or altered at any time without prior notice and/or subject to amendments as may be required by the developer, the authorities and the developer's consultants from time to time. Purchasers are advised to refer to actual information, specifications or plans as inserted in the stamped Sales and Purchase Agreement entered into between the developer and the purchaser. All drawings are merely artist impressions only.



Front Facade

Artist's Impression Only

Iris

3-Storey Link House
22' x 110'
Built-Up: 3685 / 3775 sq.ft.



Back Facade

Artist's Impression Only



Ground Floor

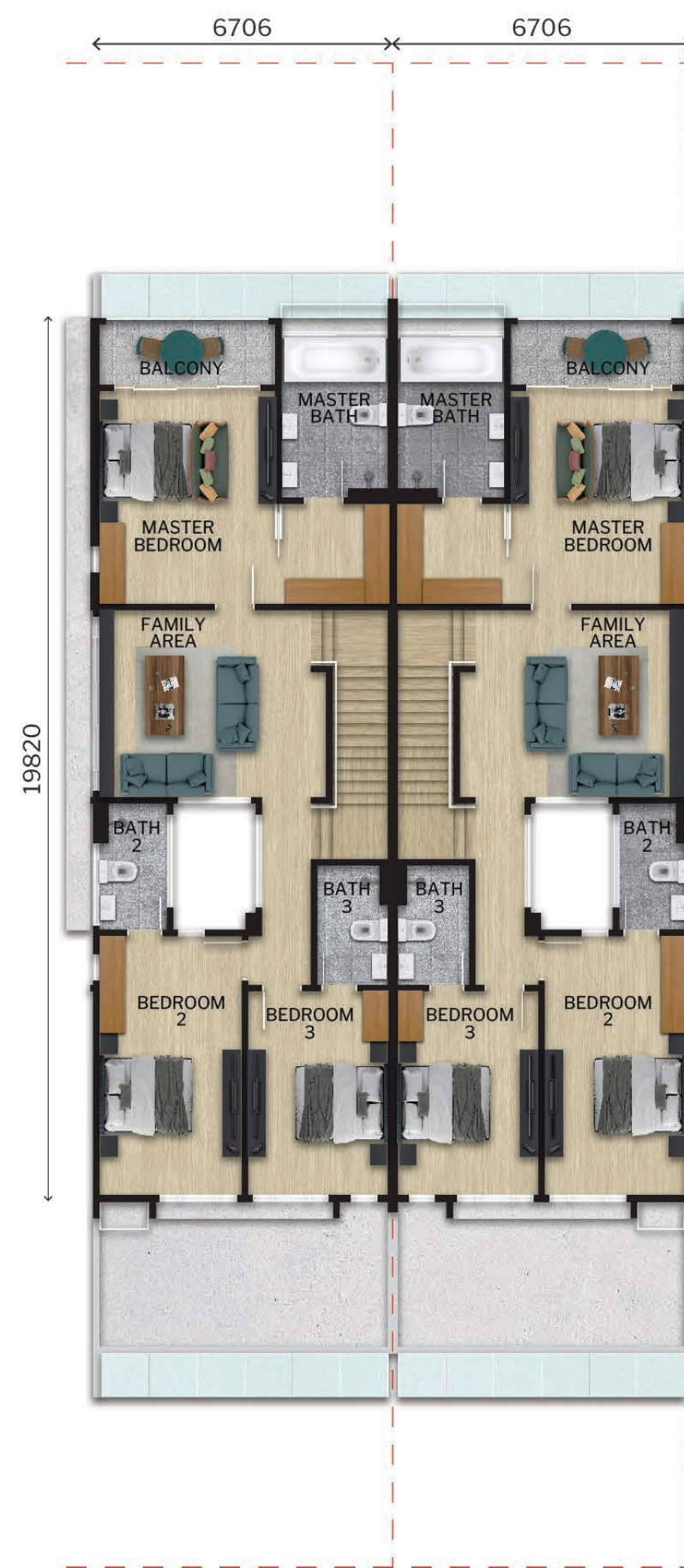

First Floor



Second Floor

Specification

Structure	: Reinforced Concrete Framework	
Wall	: Clay Bricks	
Roofing Covering	: Metal Roofing / R.C Flat Roof	
Roof Framing	: Light Weight Steel	
Ceilings	: Fibrous Plaster Ceiling / Cement Board Panel / Skim Coat	
Windows	: Aluminium Framed Glass Windows	
Doors	: Aluminium Framed Glass Doors / Plywood Flush Doors / Mild Steel Grille Door (Corner / End)	
Ironmongery	: Selected Quality Ironmongeries	
Wall Finishes	: Ceramic Wall Tiles at Bathrooms	
	: Ceramic Wall Tiles at Wet Kitchen	
Floor Finishes	Ground Floor	
	: Deck, Porch & Driveway, Kitchen, Yard, Utility, Toilet & Powder Room	: Ceramic Tiles
	: Foyer, Bedroom 4, Dining & Living	: Porcelain Tiles
	: Store	: Cement Render
	: Courtyard	: Loose Gravel Chips
Floor Finishes	First Floor	
	: Master Bedroom, 2, 3 & Family Area	: Hard wood timber Parquet
	: Master Bath, 2, 3 & Balcony	: Ceramic Tiles
Floor Finishes	Second Floor	
	: Entertainment Area	: Hard wood timber Parquet
	: Bath 4 & Outdoor Deck	: Ceramic Tiles
	: Other Areas	: Cement Render
Staircase	: R.C Staircase With Hard Wood Parquet to Tread / Plaster Finish to Riser	
Sanitary and Plumbing Fittings	: Selected Quality Sanitary Wares	
Electrical Installation	: Lighting Point	: 45 nos
	: Fan Point	: 7 nos
	: Socket Outlet Point	: 30 nos
	: TV Outlet Point	: 2 nos
	: Telephone Point	: 1 no
	: Air-con Point	: 6 nos
	: Heater Point	: 1 no
	: Bell Point	: 1 no
	: Alarm Wiring	: 1 no
	: Internet Point	: 4 nos
Internal Telephone Trunking & Cabling	: Available	
Fencing	: 3' High Galvanised Mesh Fence	

• Developer's License No: 11115/01-2028/0274 (A) (22/01/2023- 21/01/2028) • Advertisement & Sales Permit No.: 11115-8/10-2026/1114(N)-(S) (05/10/2023- 04/10/2026) • Building Type: 3 Storey Terrace House • Total units: 40 units • Selling Price: RM1,978,000.00 (min) – RM3,018,000.00 (max) • Approving Authority: Majlis Bandaraya Johor Bahru (MBJB) • Approved Plan No: MBJB/U/2022/14/BGN/111/RP (11) • Expected Date of Completion: November 2026 • Land Tenure: Freehold • Land Encumbrances: Nil • 15% discount for Bumiputera lot • Sekatan-Sekatan Kepentingan: Tanah yang terkandung di dalam hakmilik ini tidak boleh dijual atau dipindahmilik dengan apa cara sekalipun kepada Bukan Warganegara/Syarikat Asing tanpa persetujuan Pihak Berkuasa Negeri.

THIS ADVERTISEMENT HAS BEEN APPROVED BY THE NATIONAL HOUSING DEPARTMENT

Disclaimer: The information contained in this brochure may be changed or deleted or altered at any time without prior notice and/or subject to amendments as may be required by the developer, the authorities and the developer's consultants from time to time. Purchasers are advised to refer to actual information, specifications or plans as inserted in the stamped Sales and Purchase Agreement entered into between the developer and the purchaser. All drawings are merely artist impressions only.